

Installation Instructions for Slimbox 4 Fiber Indoor/Outdoor Enclosure

8/9/2017

This document describes the Assembly Instructions for the SlimBox-V, Indoor/Outdoor Enclosure – 4 fiber.

1. Products

The equipment is used as a termination point for the feeder cable to connect with the drop cable in a FTTx network. The fiber splicing, splitting, distribution can be done in the enclosure and provides a solid protection and management for the FTTx network.

Features:

- Total enclosed structure.
- Material: PC+ABS, water resistant, dust-proof, IP55
- Clamping for feeder cable and drop cable, fiber splicing, storage, and distribution.
- Cable, pigtails, patch cords individual pathways without disturbing adjacent fibers
- Easy Access to feeder cable by raising the distribution panel
- Suitable for both Outdoor and Indoor use

2. Specifications

- Environmental Requirement

Working Temperature	-40° C to + 60° C
Relative Humidity	≤ 85% (+30°C)
Atmospheric Pressure	70 Kpa ~ 106 Kpa

- Electrical Requirement

- The grounding device is isolated with the cabinet, isolation resistance is less than **1000MΩ/500V** (DC); $IR \geq 1000M\Omega/500V$
- The withstand voltage between grounding device and cabinet is not less than 3000V (DC)/minute, no puncture and no flashover; $U \geq 3000V$

Configuration Table

Parameter	
Dimension (HxWxD)	186 X 116 X 40 mm
Color	Light Gray
Material	Plastic (PC + ABS)
Adapter Type	SC or LC Duplex that fits SC footprint
No of Adapters	4 (LC Duplex that fits SC footprint)
Splitter Type	Nx 2, Nx4 and Nx8
No. of Splitters	Max. 1 (N x 2, N x 4 and N x 8)
Capacity	Max 4
IP Grade	IP 55 (Outdoor)
Mount	Wall Mount

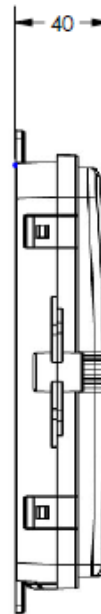
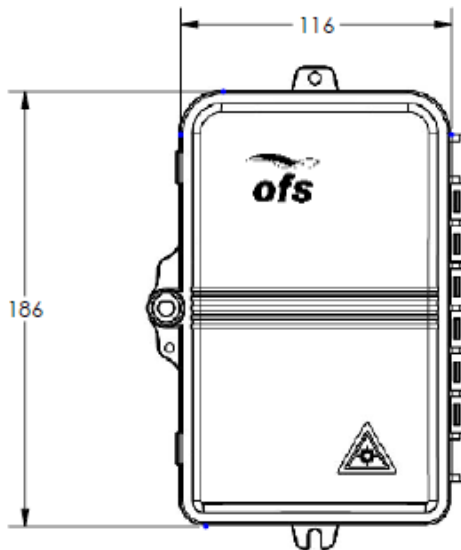
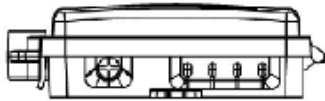

3. Product Structure and Cable Entry

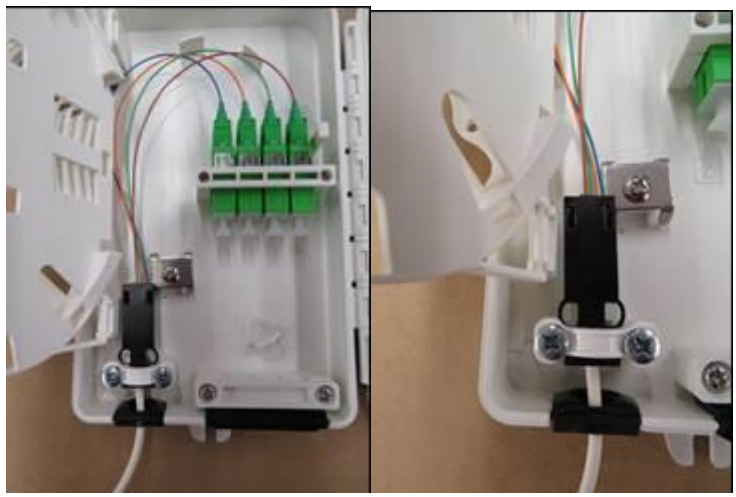
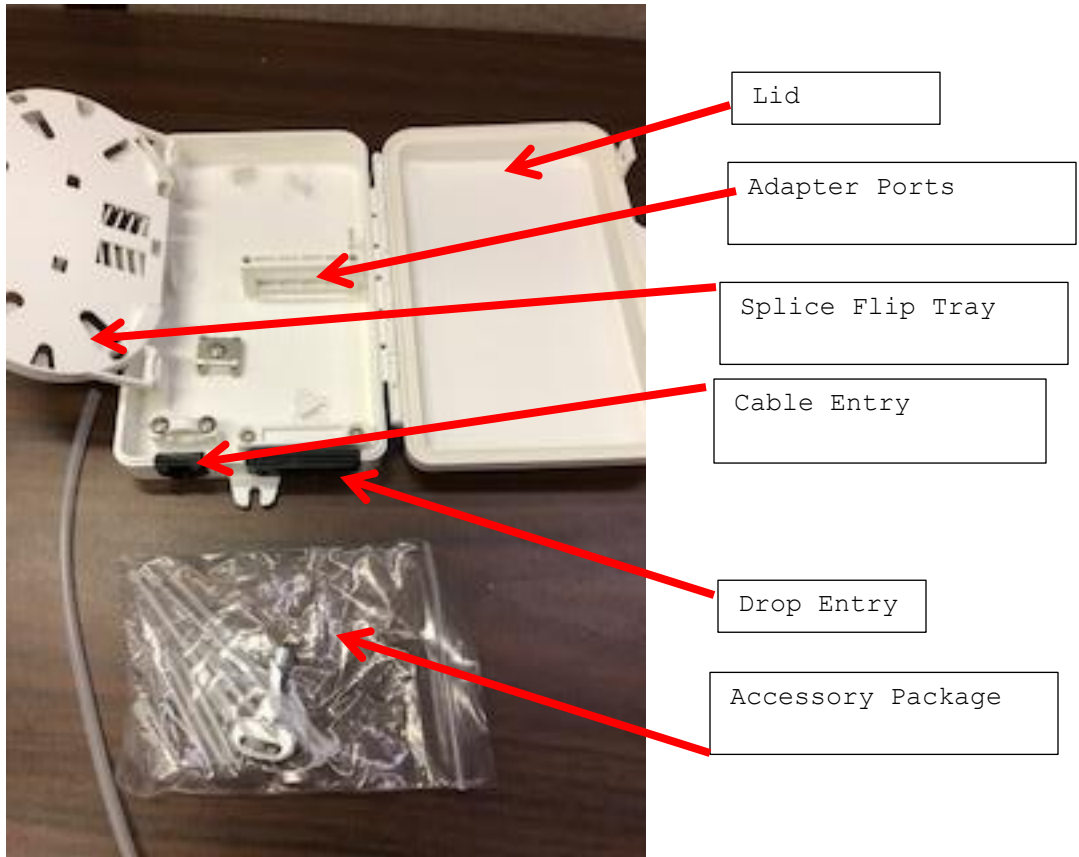

4. Enclosure Installation and drop cable attachment

1. Start by opening the accessories package and find the mounting screws included in the product packaging. Attach the screws at the top and the base of the enclosure.



2. Open the lid with a cam wrench and open the latches with a screw driver



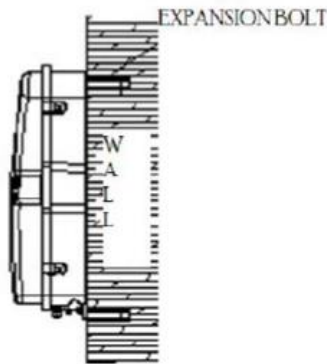

Pic 5 Wall mounted installation.

3. Remove the grommet by sliding forward and notch through the web in order for the cable to enter. Run the cable through the notch and place the grommet back in the enclosures. The cable grommet is notched in the center and the drop cable is cut from the bottom. The fiber in the Indoor/Outdoor cable is 250 um and will require an up-jacket with 900 um tubing using the D-181755 or similar kit when the installation is terminating in the enclosure. See step 6 for mid span entry of the Indoor/Outdoor cable.
4. When using OSP cable, the cable is prepped prior to inserting the cable in the cable clamp. The cable clamp and the strength member clamp are removed with a Phillips head screw driver. The strength member is prepped two inches beyond the end of the cable. The cable clamp is attached on the Outside plant cable and the prepped end is located slightly beyond the clamp. Outside plant cable can't be used in a mid-span installation. The 250 um fiber will require an up-jacket with 900 um tubing using the D-181755 or similar kit when connectorizing and the fiber is placed in a tube to transfer to the splice tray when splicing.



Strength Member Clamp

Cable Clamp

5. When field terminating connectors utilize the vendor specific instructions for direct termination, mechanical or splice on connectors for 900 um buffered fiber.
6. When doing a mid-span cable the cable enters on the left side is wrapped two times and exits on the far right hand side drop port (only three drops are allowed in the mid-span entry). The EZ Cable Clii Shark Tooth Anchors. Place the anchors close to the enclosure to assist in strain relief. The Indoor/Outdoor cable is smaller than the bracket and can be held in place with a cable tie included in the accessory package. When doing a mid-span the cable exits from one of the drop ports. The exit end of the cable is clamped into the plastic drop grip at the base of the enclosure (see the photo below).



Drop Cable Clamp: Remove the two screws with a Phillips head screwdriver and place the drops in the drop holder. Replace the top part of the clamp and replace the screws

7. When the enclosure is pre-terminated the cable will already be installed and up-jacketed and you can move to step 8 for drop installation.



8. Remove the top of the drop clamp and pull out the black grommet. Cut the base of the grommet to allow the drops to slide into the grommet before inserting it back into the enclosure. Then route the drop cables through the grommet ports and attach the connectorized end (SCU, SCA, LCU or LCA) into the adapters. Match the adapter number (molded into the base of the enclosure) with the appropriate cable number.



9. Pigtailed may be ordered with the enclosure or ordered separately. When ordered with the enclosure they will already be attached to the adapter on the base of the enclosure and the excess fiber stored in the fiber management on the front of the splice flip tray. If ordered separately then attach the pigtail into the adapter. The pigtail fiber ends will need to be routed from the rear of the flip tray to the front of the splice flip tray and prepared for splicing.



Rear of Splice Tray Cable
entry point

Rear of Splice Tray Pigtail
entry point

10. The Outside Plant cable is routed into the bottom left hand corner of the base and attached inside the bracket at the base of the enclosure. The cable is prepped with 38 inches of exposed unit tube that is routed in the base of the enclosure and routed to the rear of the flip tray. The unit tube that will be spliced is prepped 20.5 inches to expose the fiber that will be spliced to the pigtail. Once the fusion splice is completed the splice sleeve is installed on the top of the flip tray and the pigtail is routed counter clockwise and the unit tube is routed clockwise on the rear of the flip tray.

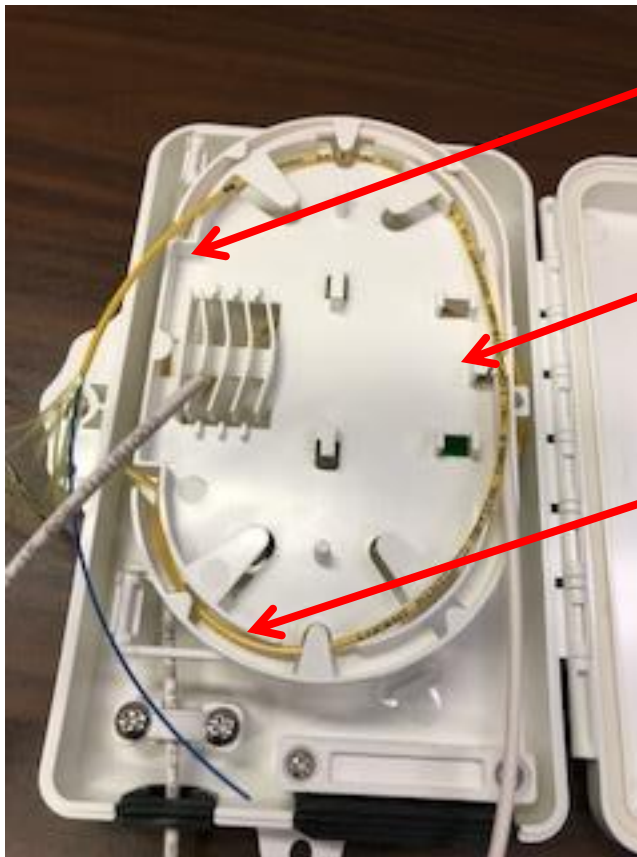

Splice Flip Tray
Indoor/Outdoor Cable entry
or tubed fiber from an OSP
cable

Splitter Attachment

Splice Flip Tray Pigtail
entry point. Pigtail is
routed counter clockwise

5. Splitter Installation

1. Attach the splitter on the top of the splice flip tray.
2. If the output ends of the splitter are pre-terminated then route the connectors to the base of the enclosure and attach the connector into the adapter. The excess fiber will be stored in the fiber management at the top of the splice flip tray.
3. If the splitter output and inputs are to be spliced to pigtails attach the pigtail connector into the adapter on the base of the enclosure to the connector of the drop lead. Then take the ends from the front of the base to the rear of the splice flip tray. Take the splitter output leads and splice the respective pigtail to the splitter output fiber.

4. The input fiber from the splitter will be spliced in the splice flip tray to the specified fiber in the incoming feeder cable.
5. Store the splice protectors and slack in the splice flip tray.
6. Record the connection information and place in the inside lid of the enclosure.
7. Close the cover and attach to the base making sure not to pinch fibers and cordage.



Ordering Information

Comcode	Product Code	Description
301139689	SLIMBOX-H,OUTDOORSVI-04FIBER-INSIDEADP	SlimBox, 4 fiber empty
301139697	WSE1S-004-SS41-GRY-SCAUNC-F	SlimBox, 4 fiber with 4 SC APC adapters
301139705	WSE1S-004-SS41-GRY-SCAUNC-F-PT	SlimBox, 4f with 4 SC APC adapters and pigtails
301139713	WSE1S-004-SS41-GRY-SCUUNC-F	SlimBox, 4 fiber with 4 SC UPC adapters
301139721	WSE1S-004-SS41-GRY-SCUUNC-F-PT	SlimBox, 4f with 4 SC UPC adapters and pigtails
301140356	WSE1W-004-SS41-GRY-SCAUNC-MIOP-0050F	SlimBox, 4f preterminated with 4f Indoor/Outdoor EZ Bend cable 50 ft.
301140364	WSE1W-004-SS41-GRY-SCAUNC-MIOP-0150F	SlimBox, 4f preterminated with 4f Indoor/Outdoor EZ Bend cable 150 ft.
301140372	WSE1W-004-SS41-GRY-SCAUNC-MIOP-0200F	SlimBox, 4f preterminated with 4f Indoor/Outdoor EZ Bend cable 200 ft.
301140380	WSE1W-004-SS41-GRY-SCAUNC-MIOP-0300F	SlimBox, 4f preterminated with 4f Indoor/Outdoor EZ Bend cable 300 ft.

Technical assistance

OFS ensures that the technical information, statements, drawings and illustrations contained in this manual are reliable. However, the information may not be sufficient to install in certain conditions OFS reserves the right to make improvements, enhancements or changes to the products without prior notification including technical data and other information related to this product.

For additional information, please contact your sales representative.

You can also visit our website at www.ofsoptics.com or call 1-888-fiberhelp (1-888-342-3743) from inside the USA or 1-770-798-5555 from outside the USA