

# EZ!Fuse 4.8mm SC Splice on Connector assembly instruction



1. Load ferrule housing into the ferrule holder. Push until it clicks. Load into the right hand side of the splicer.



2. Slide the unit of nut + tube assembly onto the cord.

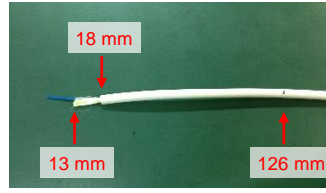

3. Mark the positions at 13 mm, 18 mm, and 126 mm and remove the outer jacket and aramid yarn.



4. Split the outer jacket lengthways at 126 mm and slide the stopper and the protection sleeve onto the fiber.

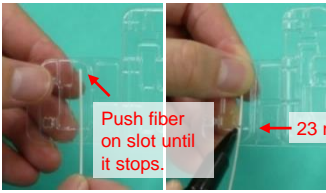

5. Mark 23 mm by measuring groove. Remove the primary and secondary coating of the fiber at 23 mm. Clean fiber with a cleaning wipes.

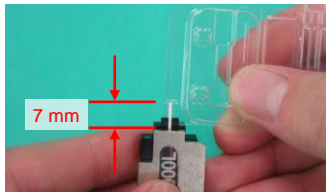

6. Use the measuring line indicated to ensure that 7 mm protrudes of the coating protrudes from the holder.

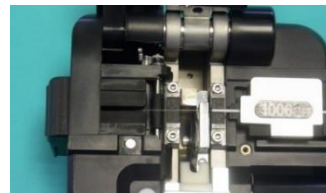

7. Cleave the fiber.



8. Load the fiber into the splicer. Splice the fibers.

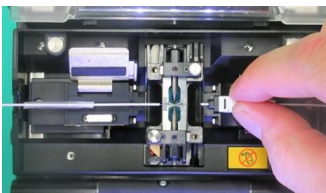

9. Remove the fiber from the left holder and release the ferrule from its holder unit on the right.

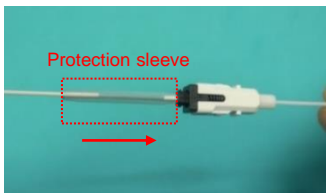

10. Slide the protection sleeve towards the ferrule housing unit.

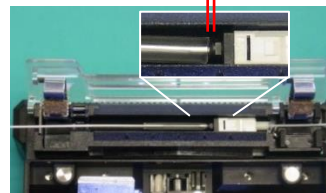

11. Put the ferrule housing unit into the heater to the right.



12. After heating, confirm shrinkage of the protection sleeve.

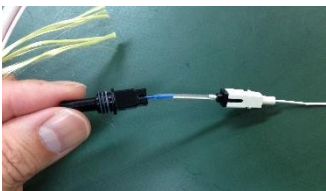

13. Slide the stopper towards the ferrule housing.

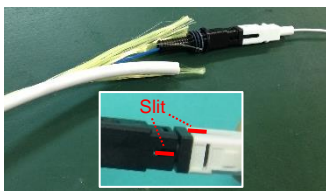

14. Align the slits at 90 degree then twist the stopper through 90 degrees until it clicks.



15. Spread aramid yarn over tail of stopper. Put the flat portion of stopper between split outer jackets. Hold aramid yarn and outer jacket by clamp.



16. Slide the nut + tube assembly towards the stopper and screw the nut until stopping.



17. Push the grip (with the direction of the same inner shape) on the housing until it clicks.



18. Connector is complete.

Fiber Holder



S712S-900-L

Ferrule Holder



S712C-SGS9C-R-P